

## RedlineGoods Civic 2016+ Armrest Installation Manual

### SIDE PARTS OF CENTER CONSOLE

**The side parts of the center console** require no special equipment or instructions -- just grab it with both hands and pull directly upward until it pops off.

Install the new cover onto the pieces. The new cover needs to be glued.

There are several kinds of glue that can be used, the 3M used below is just one of them.

Set up a staging area because the adhesive sprays pretty well out of the can.

Clean the console with a little soap and water to ensure that nothing interferes with the adhesive.

PRACTICE lining the leather up on the armrest. Decide where you are going to lay the leather on the console after the adhesive has been applied - once you have sprayed the glue and put the parts together, it's very tough to pull apart. The leather pattern is cut precisely.

Spray the adhesive on the console and the back of the leather. Follow the directions on the can. Be careful that you don't get any on the front of the leather.

Don't worry if it looks like the adhesive seeps through to the finished side of the leather. It does leave some marks on the good side while it's wet, but that goes completely away when this dries in about an hour.

Installation is the reverse of removal.

### DOOR ARMREST COVERS

**(Passenger-side door is exactly the same/symmetrical, except it is a little easier because there is only one electrical connector, instead of three.)**

Turn the car on, roll both front windows all the way down, then turn the car off. Pry the power window switch panel off, starting at the front and going around, until it is fully detached:





Detach the two exposed connectors by pressing and holding the pins while pulling the connector out:

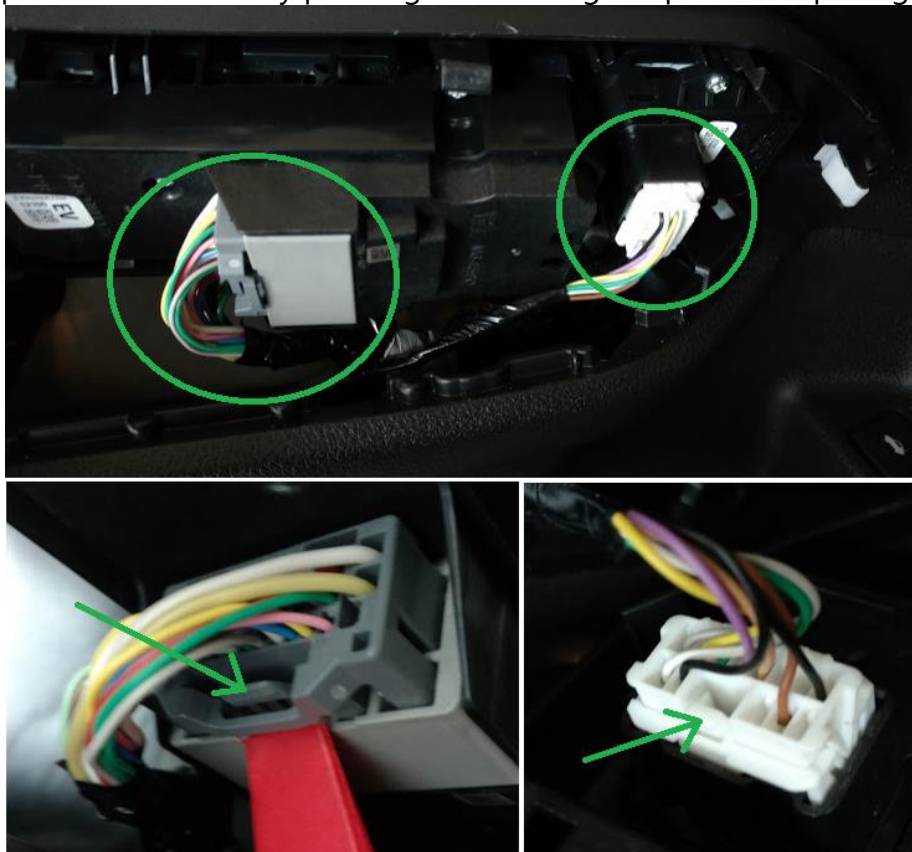

Remove the exposed screw:

**Redline Automotive Accessories Corp. will not be held liable for any labor, incidental or consequential damages of any kind. Proceed at your own risk.**



Start prying off the door panel, at the bottom-front under the speaker. Once the initial clip is popped, use your fingers to pull the panel off, popping the rest of the clips, working your way from the bottom around both sides toward the top.



**Redline Automotive Accessories Corp. will not be held liable for any labor, incidental or consequential damages of any kind. Proceed at your own risk.**

RedlineGoods.com – All rights reserved. Use for advertising competing products will be prosecuted.

With the bottom clips detached, carefully pry the top hard plastic layer from the door frame/rubber seal. Once there is enough room for your fingers, use your hands to detach the top of the panel from the frame by pulling it back and up:



*[Driver-side only]* Once the door panel is completely off, detach the remaining connector:

**Redline Automotive Accessories Corp. will not be held liable for any labor, incidental or consequential damages of any kind. Proceed at your own risk.**



Unscrew these 5 screws to detach the armrest

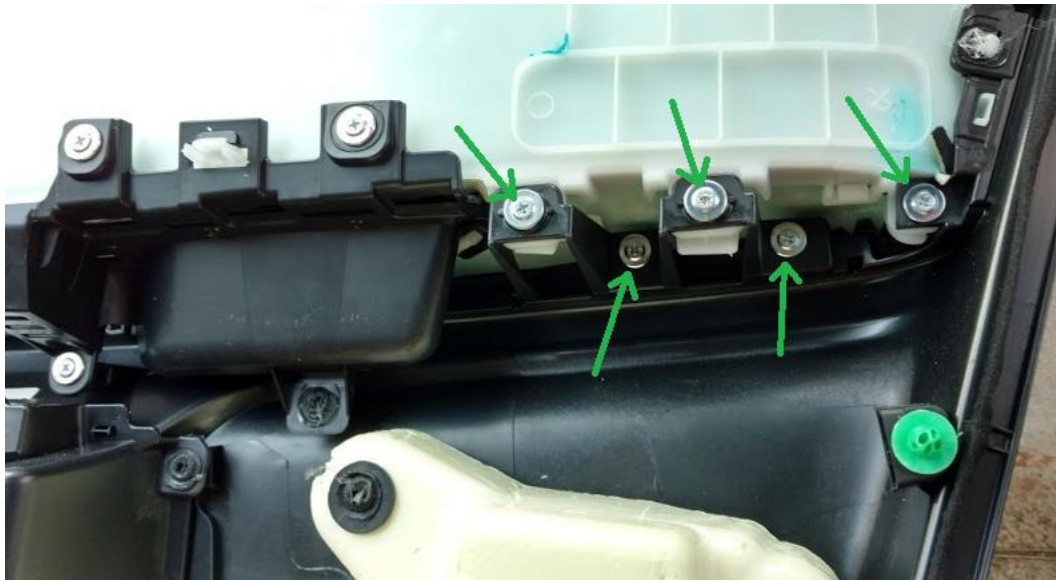

Proceed to glue the door amrest covers over the door armrests (see page 1 for detailed instructions).

Reinstall the door panels in the reverse order of removal and ENJOY!

**Redline Automotive Accessories Corp. will not be held liable for any labor, incidental or consequential damages of any kind. Proceed at your own risk.**